

TT20/TT21 SERIES TECHNICAL SPECIFICATIONS

TT20

Combustion chamber W/D: 340/271 Weight in kg: 117

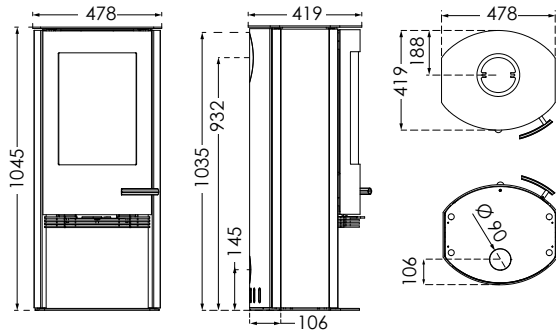

TT20R/TT21R/TT21RL/TT21RH

Combustion chamber W/D: 340/271
Weight in kg: 117/126/121/128

* Applies to models: TT21R/TT21RL/TT21RH

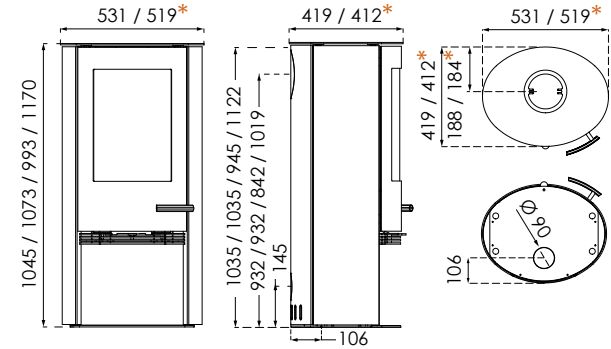

TT20S

Combustion chamber W/D: 340/271 Weight in kg: 147

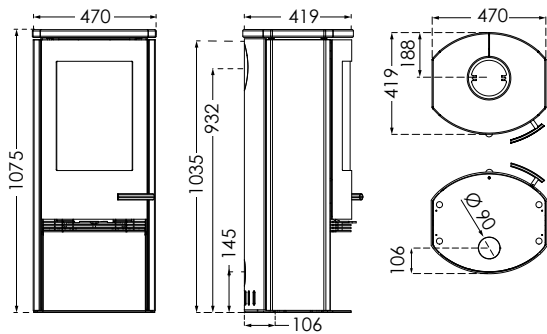

TT20RS/TT21RS/TT21RLS/TT21RHS/ TT21RS-SA/TT21RS-WH

Combustion chamber W/D: 340/271
Weight in kg: 169/174/168/181

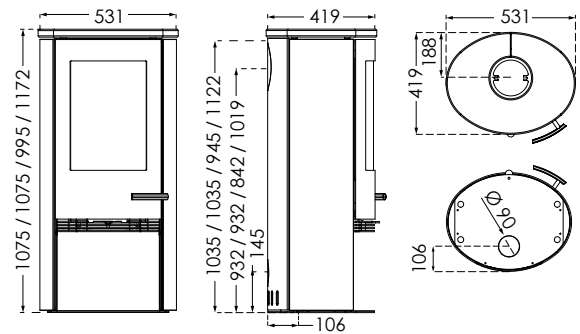

TT20RS/TT21RS

+ Heat storage module
+ Footing Stone

Combustion chamber W/D: 340/271
Weight in kg: 285/290

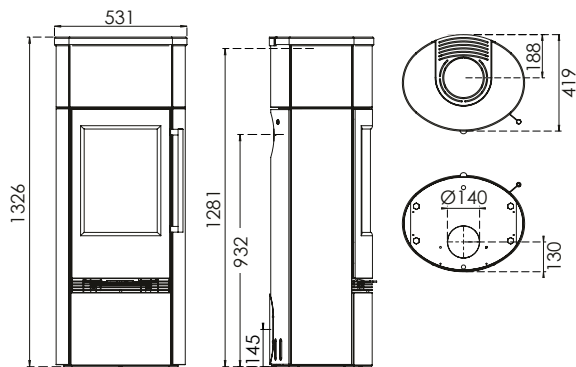

TT21SA

Combustion chamber W/D: 340/271 Weight in kg: 139

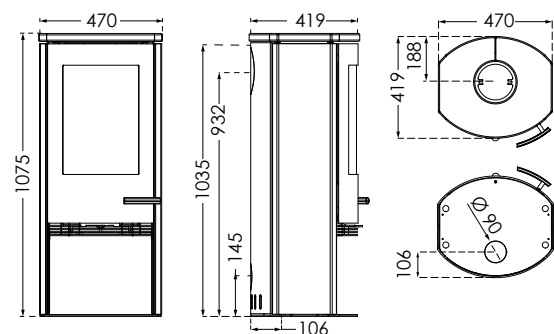

TT20/TT21 SERIES TECHNICAL SPECIFICATIONS

TT20BAZIC

Combustion chamber W/D: 340/271 Weight in kg: 99

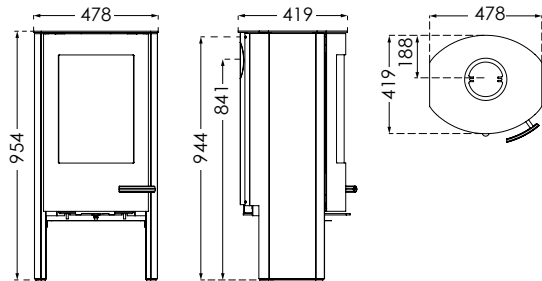

TT20BAZIC R

Combustion chamber W/D: 340/271 Weight in kg: 99

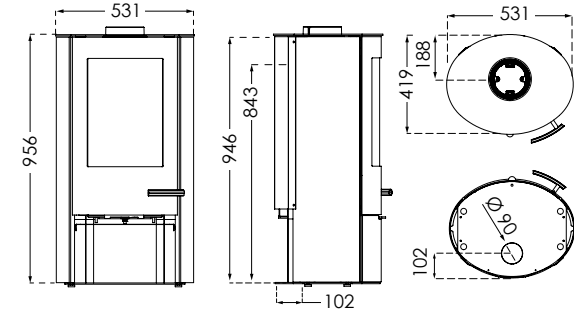

TT21RHS + Heat storage module + Footing Stone

Combustion chamber W/D: 340/271 Weight in kg: 301

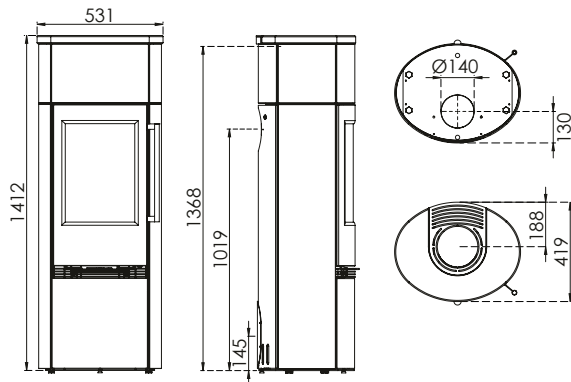

DISTANCE TO COMBUSTIBLE MATERIAL

TT20/TT21 SERIES

WITH UNINSULATED FLUE PIPE

TT20 + TT20S + TT20BAZIC + TT21SA + TT20R + TT20RS + TT20BAZIC R + TT21R + TT21RS + TT21RL + TT21RLS + TT21RH + TT21RHS + TT21RS-SA + TT21RS-WH

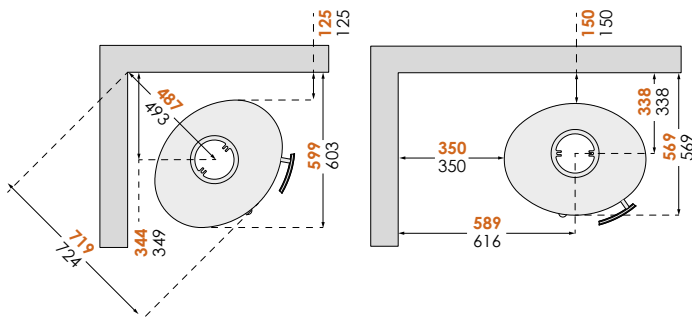

WITH INSULATED FLUE PIPE

TT20 + TT20S + TT20BAZIC + TT21SA + TT20R + TT20RS + TT20BAZIC R + TT21R + TT21RS + TT21RL + TT21RLS + TT21RH + TT21RHS + TT21RS-SA + TT21RS-WH

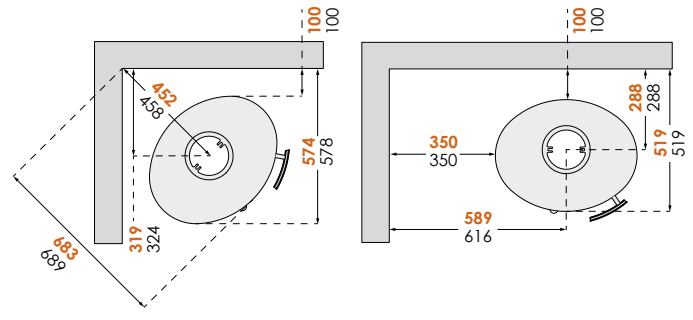

In order to avoid discolouration of painted and treated surfaces, TermaTech recommends the same distance from flammable materials as for non-flammable materials. This distance increases the convection itself around the stove and also eases cleaning. All distances relate solely to the distance of the stove from flammable materials. No account has been taken of national requirements for the use of stove flues or their distance from flammable materials.

NB! All height dimensions are without adjusting feet. Measurements are in mm.